

THE HOMESTEAD

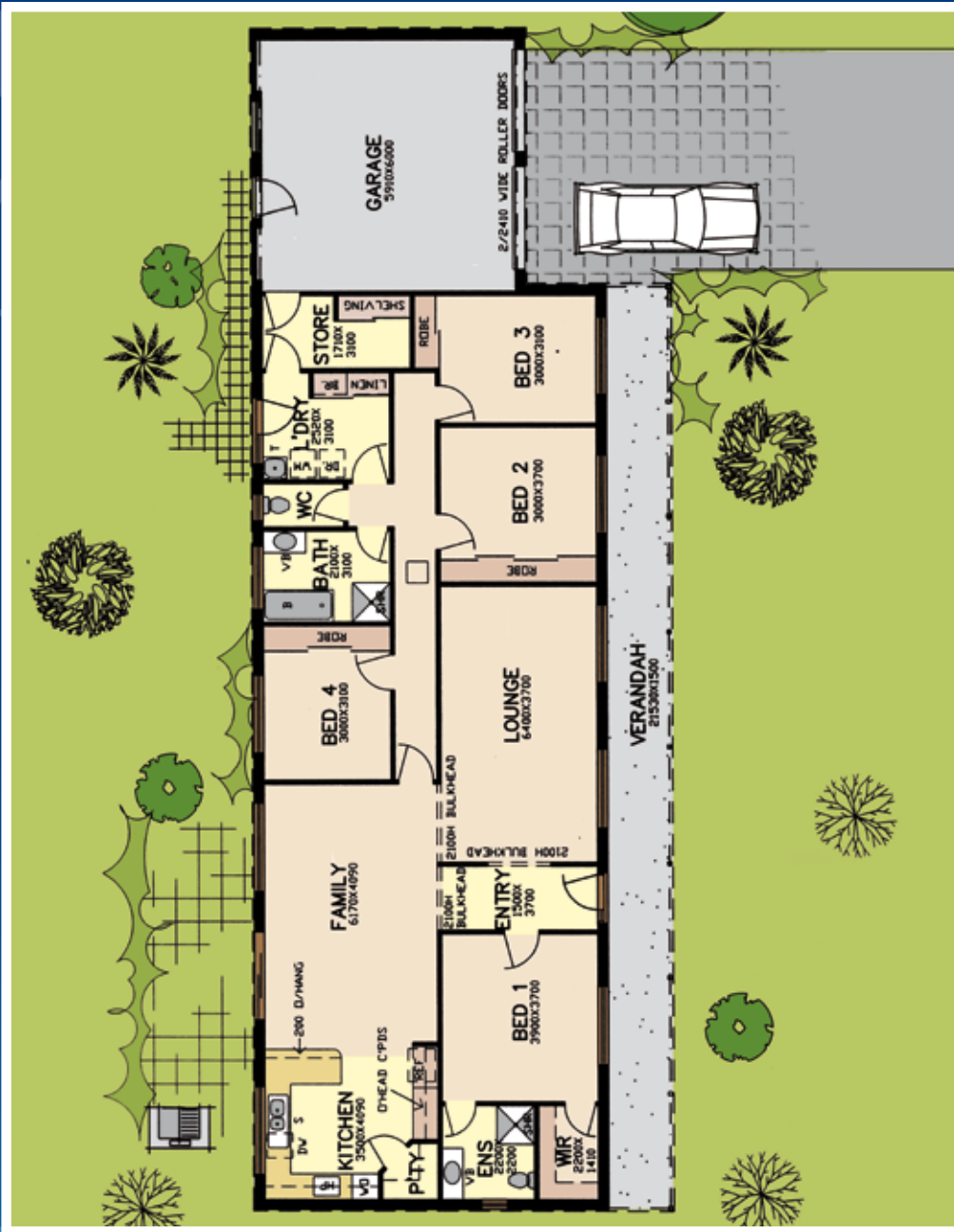

COMPLETED



Inclusions:

- Five Star Rated
- Connections
- Tiling
- Carpet
- Watertank
- Stainless Steel appliances
- Door Stops
- Towel Rails
- Keyed Window Locks
- Toilet Roll Holders
- Fly Screens
- Mirrors
- Soap Holders



*Shown with optional 2.7m ceilings

THE HOMESTEAD

SPECIFICATIONS

DESIGN

Plans and specifications to council approval.
Soil test & slab on ground design to class M soil.
Floor to ceiling height 2400 allowed.

AREA

House	179.02m ²
Garage	39.72m ²
Verandah	32.29m ²
Total	251.03m ² = 26.99sq

AUTHORITIES

Building permit fees.
Home warranty insurance.
Connections to a standard 660m² site.

CONCRETE

Slab on ground to class 'M' soil.

BRICKWORK

Bricks supplied from our standard range.
Brick on edge window sills.
Natural mortar.

CARPENTRY

Wall frame: Pine.
Roof frame: Trusses.

WINDOWS

Aluminium, sliding, with powder coat finish, locks and insect screens.

DOORS

Front door: P.CL4.
Laundry door: ALUM S/D.
Internal doors: Pressed panel.
Door furniture: Gainsborough Whitehall

PLASTER

Walls and ceiling: 10mm plasterboard.
Wet areas: Villaboard & 10mm wet board.
Cornice: 55mm cove.

ROOFING

Corrugated zinc.
Colorbond fascia.
Colorbond gutters.

INSULATION

Ceilings: R3.5 batts. (house only)
Walls: R2.0 batts. (external)

ELECTRICAL

Light points: 20.
Power points: 14 double.
Exhaust fans: 2.
Smoke detectors: 2.
Television points: 1.
Phone points: 1.
Dishwasher point: 1.
Connections to Rangehood, Oven, Cooktop & heating

BATHWARE

Basins: White & chrome fixtures.
Bath: 1675 white.
Shower screen: Clear glass, pivot door.
Tapware: BW Homes Crosshandle.
Sink: 1 1/2 bowl stainless steel.
Toilets: Caroma, Slimline.
Laundry tub: 45 Litre with cabinet.
Towel rail: BW Homes chrome single.
Paper holder: BW Homes chrome.

JOINERY

Kitchen cabinets: Laminate doors, post form tops.
Bathroom vanities: Laminate doors, post form tops.
Linen press: 4 shelves.
Wardrobes: 1 shelf with hanging bars.
Architraves: 65mm
Skirtings: 65mm bevelled edge (Primed Pine).

HEATING

1 Electric Pureheat heaters (alpha) AL35R

OTHER

Technika wall oven TO56FSS.
Cooktop H640SXPRO. Rangehood. SL1/01/60.
Hot water service: 400 litre twin element.
Mirrors to bathroom/ensuite.
Tiling to wet areas and entry.
2000 lt Rain Water Tank connected to toilets

E&OE



ABN 98 101 152 514 DB U25318
318 PAKINGTON ST, NEWTOWN

P. 03 5229 0789 F. 03 5221 5250 E. admin@walkergeelong.com.au

www.barrywalkerhomes.com.au